

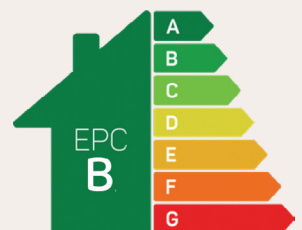

The Bretton

3 bed semi-detached

Perfect for families and first-time buyers, this three-bedroom semi-detached home has plenty of space. The heart of the home is the modern open-plan kitchen/diner, with French doors leading to the garden. Upstairs, you'll find two double bedrooms and a single, with the master boasting a luxurious en-suite. Plus, there's a family bathroom to make busy mornings easier.



Predicted EPC rating

Ground Floor Plan

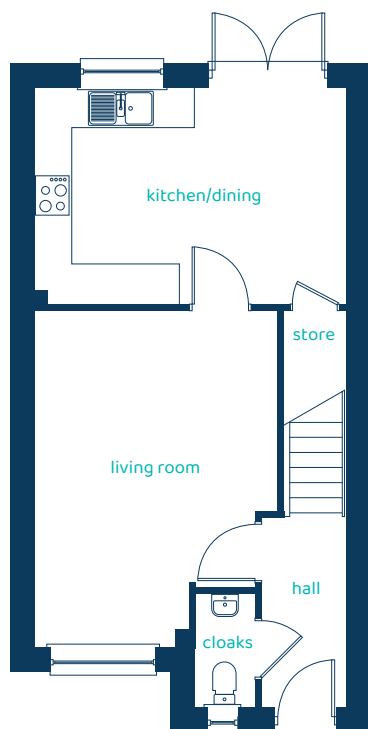

Room	Imperial	Metric
Kitchen/Dining	15'6" x 10'9"	4.73m x 3.27m
Living Room	12'2" x 16'9"	3.71m x 5.10m
Cloaks	2'11" x 5'7"	0.90m x 1.70m

First Floor Plan

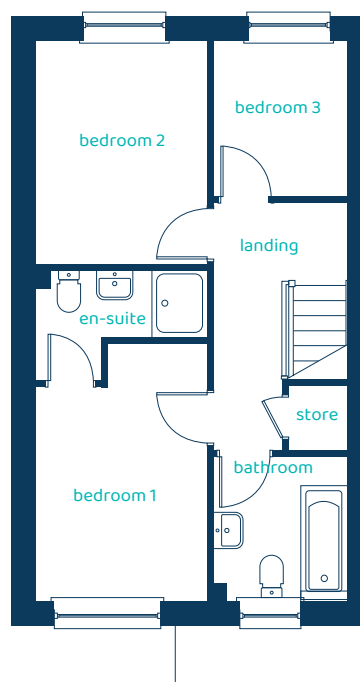

Room	Imperial	Metric
Bedroom 1	8'6" x 12'9"	2.59m x 3.88m
En-suite	8'6" x 5'6"	2.59m x 1.67m
Bedroom 2	8'6" x 11'1"	2.59m x 3.37m
Bedroom 3	6'9" x 7'8"	2.05m x 2.35m
Bathroom	6'9" x 7'2"	2.05m x 2.18m

The Bretton

3 bed semi-detached

Anwyl Homes is a Registered Developer with the NHQB. This is a computer-generated image of the Bretton, elevation treatment may vary. Room sizes are approximate, dimensions are taken from the longest room point (please consult homes advisor for measurement points). Plots may be handed and any garages may be single or double. Kitchen and bathroom layouts are indicative. These plans are correct at the time of going to press, but may be subject to change during construction. Please ensure that you check for specific plot details. Kitchen islands are an optional upgrade to this house type. 14/04/25.

